

Dual purpose, top-entry accelerometer with 100mV/g AC and 4-20mA DC outputs. Made from robust stainless steel throughout for long term vibration analysis in harsh environments. Sealed to IP67 and includes 62GB 3-pin connector. Available with a wide range of mountings.

MTN/1186

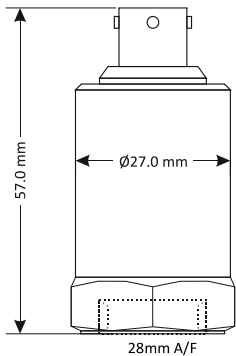

Dimensions



Pin A — +ve (4-20mA loop)
Pin B — AC output
Pin C — 0V (4-20mA loop)

Applications

- Air handling units
- Building services
- Fans

Technical

Output current	4-20mA DC proportional to rms velocity (mm/s)
----------------	---

AC output	Voltage proportional to acceleration (g)
-----------	--

Supply voltage range	12-32V DC (4-20mA)
----------------------	--------------------

Frequency response (mm/s)	2Hz to 1kHz $\pm 10\%$
---------------------------	------------------------

Frequency response (g)	-3dB @ 0.8Hz
------------------------	--------------

Mounted base resonance	5kHz (nominal)
------------------------	----------------

Isolation	Base isolated
-----------	---------------

Dynamic range	30g peak for 100mV/g 60g peak for 50mV/g
---------------	---

Transverse sensitivity	Less than 5%
------------------------	--------------

Operating temperature	-25 to 90°C
-----------------------	-------------

Temperature sensitivity	0.08%/°C
-------------------------	----------

Bias voltage (AC output)	3V DC (nominal)
--------------------------	-----------------

Case material	Stainless steel
---------------	-----------------

Mating connector	MTN/MH008
------------------	-----------

Mounting torque	8Nm
-----------------	-----

Weight	150g (nominal)
--------	----------------

Sealing	IP67
---------	------

Studs and grub screws



Part #	From	To
MS036	¼"-28 UNF Male	M6 Male
MS039	¼"-28 UNF Male	10-32 UNF Male
MS067	¼"-28 UNF Male	M8 Male
MS068	¼"-28 UNF Male	¼"-28 UNF Male
MS124	¼"-28 UNF Male	M10 Male
MS132	¼"-28 UNF Male	M12 Male

Quick fit adapters

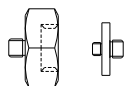

Part #	From	To
MS001	Q/F Male	Glue base
MS002	Q/F Male	M8 Male
MS003	Q/F Male	M10 Male
MS004	Q/F Male	¼"-28 UNF Male
MS006	Q/F Male	M6 Male

Options

- Filters
- Mounting threads
- Mating connectors and cable assemblies
- High temperatures
- Other velocities (see below)

Part #	Mounting	xx = Optional velocity (mm/s rms)	xx = Optional sensitivity (mV/g)
MTN/1186-xx	¼"UNF Female	0-10	100mV/g
		0-20	100mV/g
		0-25	100mV/g
MTN/1186Q-xx	Q/F Female	0-50	50mV/g
		0-100	50mV/g

Mounting adapters

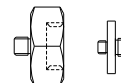

Part #	From	To
MS005	Q/F Male	¼"-28 UNF Female
MS007	Q/F Male	10-32 UNF Female
MS008	Q/F Male	M8 Female
MS011	¼"-28 UNF Male	Q/F Female
MS013	¼"-28 UNF Male	Glue base
MS033	¼"-28 UNF Male	Q/F Female
MS038	Q/F Male	M8 Conical Male
MS061	¼"-28 UNF Male	10-32 UNF Male
MS079	¼"-28 UNF Male	Q/F Female
MS106	Q/F Male	M10 Female

Isolation

Part #	From	To
MS034	¼"-28 UNF Male	¼"-28 UNF Female
MS093	Q/F Male	M8 Male

System connection

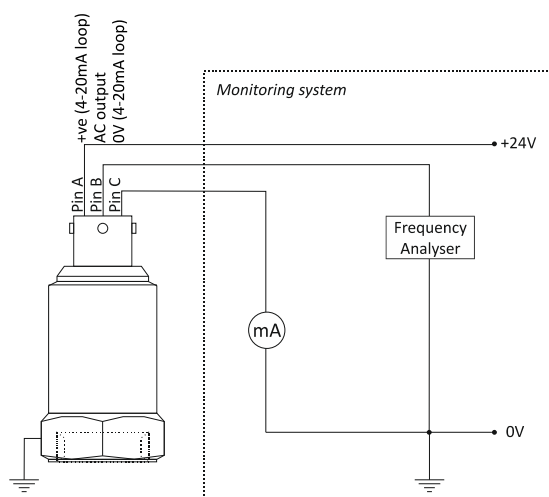

To avoid spurious signals, the body of the sensor must be grounded by the machine or by a grounded connector shell. The monitoring system 0V should also be grounded.