

Small footprint, general purpose, top-entry constant current accelerometer with an isolated AC output. Made from robust stainless steel throughout for long term vibration analysis in harsh environments. Sealed to IP67 and includes 2-pin C5015 military style connector. Available with a wide range of mountings and 19mm diameter base.

MTN/1170

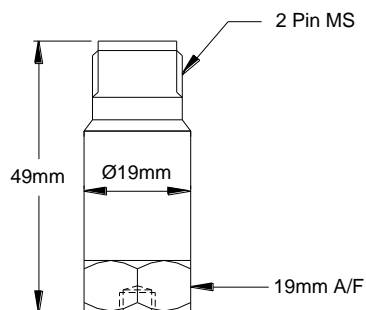

Dimensions



Applications

- Portable Data Collector
- General Industry
- Pumps, fans, etc.
- Air Handling Units

Technical

Standard Sensitivity	100mV/g +/-10% nominal at 80Hz
Frequency Response	2Hz to 12kHz +/-5%, (-3dB at 0.5Hz)
Mounted Base Resonance	22kHz (min)
Isolation	Base Isolated
Dynamic Range	+/-50g
Transverse Sensitivity	Less than 5%
Current Range	0.5mA to 6mA
Temperature Range	-25 to 120°C
Temperature Sensitivity	0.08 %/°C
Bias Voltage	12 Volts DC (nominal)
Case Material	Stainless Steel
Mounting Torque	8Nm
Weight	40gms (nominal)
Sealing	IP67
Mating Connector	MTN/MH002

Mounting Adaptors and Studs

Studs and Grub Screws



Part #	From	To
MS036	¼"-28 UNF Male	M6 Male
MS039	¼"-28 UNF Male	10-32 UNF Male
MS067	¼"-28 UNF Male	M8 Male
MS068	¼"-28 UNF Male	¼"-28 UNF Male
MS124	¼"-28 UNF Male	M10 Male
MS132	¼"-28 UNF Male	M12 Male

Quick Fit Adaptors

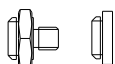

Part #	From	To
MS010	Q/F Male	Glue base
MS055	Q/F Male	M8 Male
MS072	Q/F Male	M6 Male
MS102	Q/F Female	10-32 UNF Male
MS117	Q/F Male	¼"-28 UNF Male

ORDER CODE PART No	MOUNTING
MTN/1170	¼" UNF Female
MTN/1170Q	Quick Fit Female

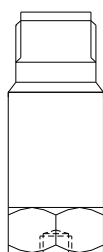

Other Adapters

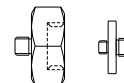

Part #	From	To
MS011	¼"-28 UNF Male	Q/F Female
MS013	¼"-28 UNF Male	Glue base
MS033	¼"-28 UNF Male	Q/F Female
MS061	¼"-28 UNF Male	10-32 UNF Male
MS079	¼"-28 UNF Male	Q/F Female

Isolation Adaptors

Part #	From	To
MS034	¼"-28 UNF Male	¼"-28 UNF Female
MS027	M6 Male	M6 Female

System Connection Details

